

# Soils Map

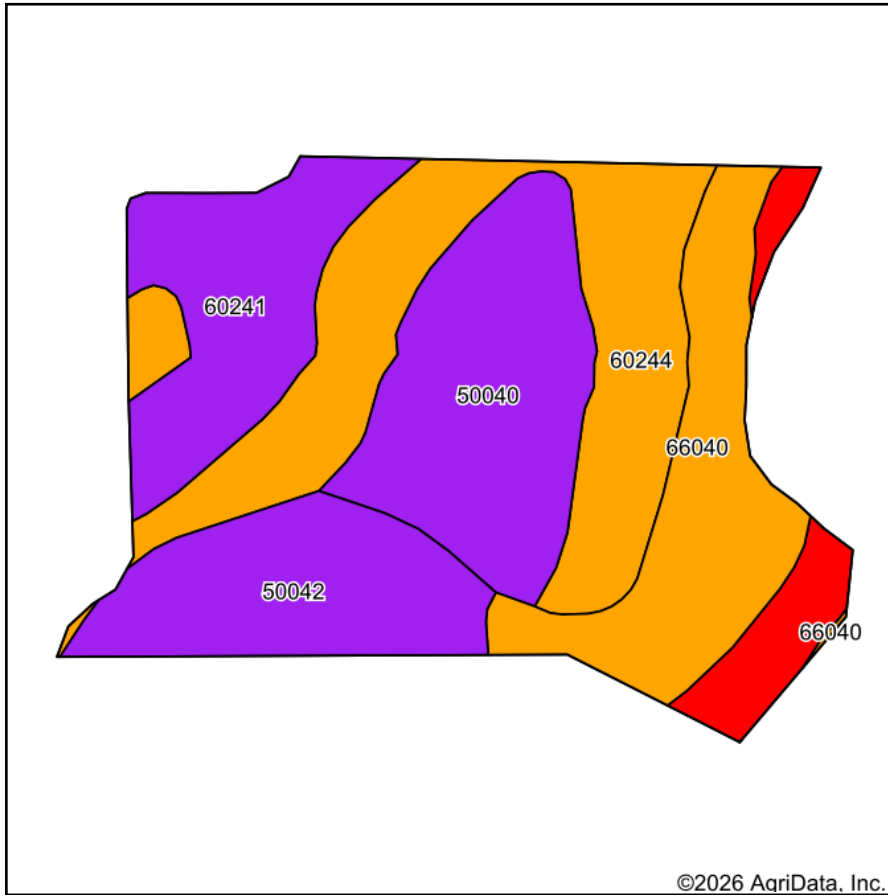

Soils data provided by USDA and NRCS.

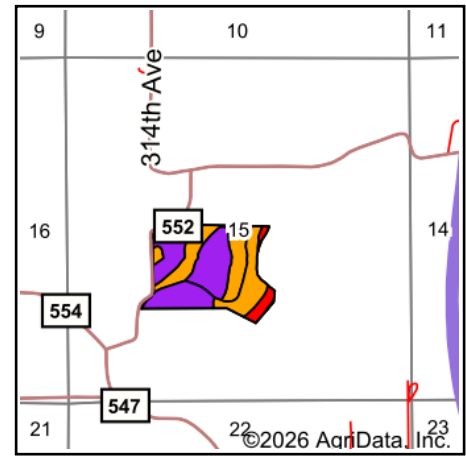

State: **Missouri**  
 County: **Lewis**  
 Location: **15-61N-6W**  
 Township: **Union**  
 Acres: **53**  
 Date: **1/22/2026**

Maps Provided By:  
  
 CUSTOMIZED ONLINE MAPPING  
 © AgriData, Inc. 2025 www.AgriDataInc.com



Area Symbol: MO111, Soil Area Version: 29

Code	Soil Description	Acres	Percent of field	Non-Irr Class Legend	Non-Irr Class *c	Corn Bu	Grass legume hay Tons	Grass legume pasture Tons	Soybeans Bu	Wheat Bu	*n NCCPI Corn	*n NCCPI Soybeans
60244	Winfield silt loam, 5 to 10 percent slopes, eroded	14.46	27.4%		IIIe	132	4.1	6.8	40	52	79	65
50040	Lindley loam, 14 to 20 percent slopes, eroded	10.93	20.6%		Vle						65	50
66040	Kickapoo fine sandy loam, 0 to 2 percent slopes, frequently flooded	8.87	16.7%		IIIw						53	39
50042	Lindley loam, 20 to 35 percent slopes, eroded	7.91	14.9%		Vle						46	31
60241	Winfield silt loam, 14 to 25 percent slopes	7.84	14.8%		Vle						63	54
99001	Water	2.99	5.6%		VIII							
<b>Weighted Average</b>					<b>4.79</b>	<b>36</b>	<b>1.1</b>	<b>1.9</b>	<b>10.9</b>	<b>14.2</b>	<b>*n 60</b>	<b>*n 47.2</b>

\*n: The aggregation method is "Weighted Average using all components"

\*c: Using Capabilities Class Dominant Condition Aggregation Method

Soils data provided by USDA and NRCS.